

200 UNION

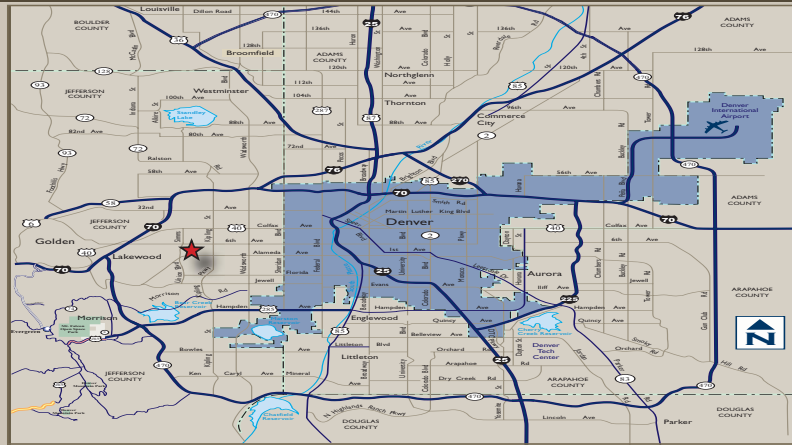

The information contained herein, while not guaranteed, has been secured from sources we believe to be reliable.

STOUT | BRADLEY
OFFICE SERVICES GROUP

W. RYAN STOUT | 303.572.5558
ryan.stout@grubb-ellis.com
NATHAN J. BRADLEY | 303.572.5503
nate.bradley@grubb-ellis.com
ZACHARY T. WILLIAMS | 303.572.5561
zach.williams@grubb-ellis.com

Grubb & Ellis
Property Solutions Worldwide
www.grubb-ellis.com

200 UNION



COMING SOON!
NEW OWNERSHIP | NEW FINISHES | NEW SPEC SUITES | NEW LANDSCAPING

200 UNION BOULEVARD | LAKEWOOD, COLORADO

ANOTHER PROJECT BY:



STOUT | BRADLEY
OFFICE SERVICES GROUP

W. RYAN STOUT | 303.572.5558
ryan.stout@grubb-ellis.com
NATHAN J. BRADLEY | 303.572.5503
nate.bradley@grubb-ellis.com
ZACHARY T. WILLIAMS | 303.572.5561
zach.williams@grubb-ellis.com

Grubb & Ellis
Property Solutions Worldwide
www.grubb-ellis.com

200 UNION

200 UNION BOULEVARD | LAKEWOOD, COLORADO

BUILDING INFORMATION

Year of Construction	1981
Land Area	5.247 Acres
Net Rentable Area	101,452 RSF
Number of Stories	Six (6)
Number of Elevators	Two (2) Passenger
Typical Floorplate	15,700 RSF
Parking	4.2:1,000 RSF overall building ratio; 424 surface spaces
Electric	Electrical power consists of 2,500 amp, 277/480 volt, 3-phase and 4 wire service
Window Mullion Spacing	5'
Finished Ceiling Height	8' to 10'



200 UNION

200 UNION BOULEVARD | LAKEWOOD, COLORADO



BUILDING AMENITIES

- ▶ On-site conference facility, showers and storage
- ▶ Great mixed-use development with on site retail amenities including Jason's Deli, Subway, Super Cuts, Tuk-Tuk Thai Express, 240 Union, Bisque Bistro and Ghin Sushi
- ▶ Ideally located with excellent access to 6th Avenue, 1-25, 1-70 and the Central Business District
- ▶ Walking distance to unlimited retail and dining options along Union Boulevard
- ▶ Adjacent to the future light rail station and St. Anthony's Hospital