

AERIAL



CORPORATE 25



7200 ALTON WAY
CENTENNIAL, COLORADO



1515 Arapahoe Street, Suite 1200 | Denver, Colorado 80202 | 303.292.3700 Office | 303.534.8270 Fax | www.fullercompany.com

For more information contact:

DOUG WULF
303.312.4218
dwulf@fullercompany.com

JOE SIGDESTAD
303.312.4245
jsigdestad@fullercompany.com

DAN MILLER
303.312.4272
dmiller@fullercompany.com



PROPERTY INFORMATION

CORPORATE 25



Corporate 25 is a completely renovated office building located in the heart of the Denver southeast suburban office market. Recent project improvements include: lobby renovation; building exterior; landscaping; corridors; bathrooms; HVAC systems and parking lot. With improved access via Dry Creek Road, Corporate 25 offers prominent identity along I-25, unobstructed western views and Class "A" finishes throughout. Corporate 25 also features tremendous parking availability, upgraded power and telecommunications, and an aggressive new ownership.



TYPICAL FLOORPLAN

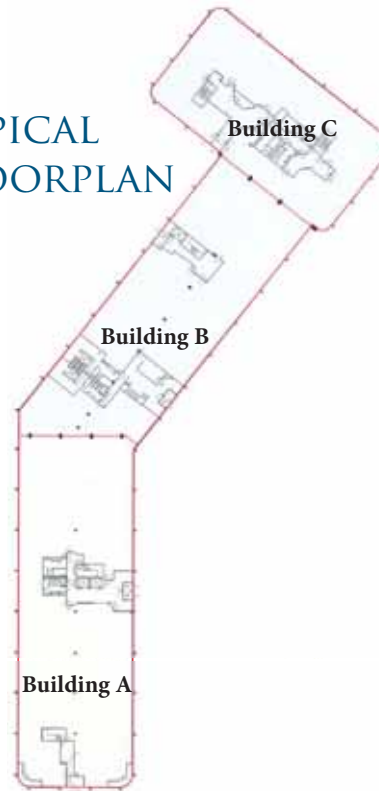

BUILDING I



BUILDING SPECIFICATIONS

- Total Building Size: 134,350 SF
- Floors: Four
- Floorplate: 33,587 SF
- Year Built: 1981
- Parking: 4.88:1,000
- Signage: Building and Monument Signage Available for Larger Tenants
- Telecommunications: Redundant Qwest Fiber (7 Providers in Street)
- Owner: Crown West Realty
- Generator: 800 KW Generator with 1,500 Gallon Diesel Tank
- Power: 3,000 Amps and 480 Volts of Power
- Security: 24 Hour Security Card Access

7200 ALTON WAY
Centennial, Colorado

ALL INFORMATION CONTAINED HEREIN IS FROM SOURCES WE DEEM RELIABLE, BUT WE MAKE NO WARRANTIES, EXPRESSED OR OTHERWISE, AS TO ITS ACCURACY. WE ASSUME NO LIABILITY FOR ERRORS OR OMISSIONS OF ANY KIND, CHANGE OF PRICE, RENTAL OR OTHER CONDITIONS, INCLUDING, WITHOUT LIMITATIONS, PRIOR SALE, LEASE OR FINANCING, OR WITHDRAWAL WITHOUT NOTICE. THIS PRESENTATION IS FOR INFORMATION ONLY AND UNDER NO CIRCUMSTANCES WHATSOEVER IS TO BE DEEMED A CONTRACT, NOTE, MEMORANDUM OR ANY OTHER FORM OF BINDING COMMITMENT. #19336 - Office

