

Two Gateway Centre

3200 Gateway Centre Boulevard Morrisville, NC 27560



Features:

- Up to 34,339 SF available
- Office/Flex Space for Lease
- Rental Rate: \$12.00/SF, NNN
- Ideal location off of Aviation Parkway
- Within one mile of Raleigh-Durham International Airport
- Easy access to I-40 and I-540
- Built in 2001
- Ample parking
- Tilt-up concrete and glass construction with glass line encompassing the entire exterior of the building
- Close proximity to numerous restaurants, banks and shopping

For more information
please contact:

Lee Clyburn, SIOR
Senior Vice President
919.420.1568
lee.clyburn@tlgcre.com

Dave Mester
Real Estate Advisor
919.420.1583
dave.mester@tlgcre.com

Two Gateway Centre

3200 Gateway Centre Boulevard Morrisville, NC

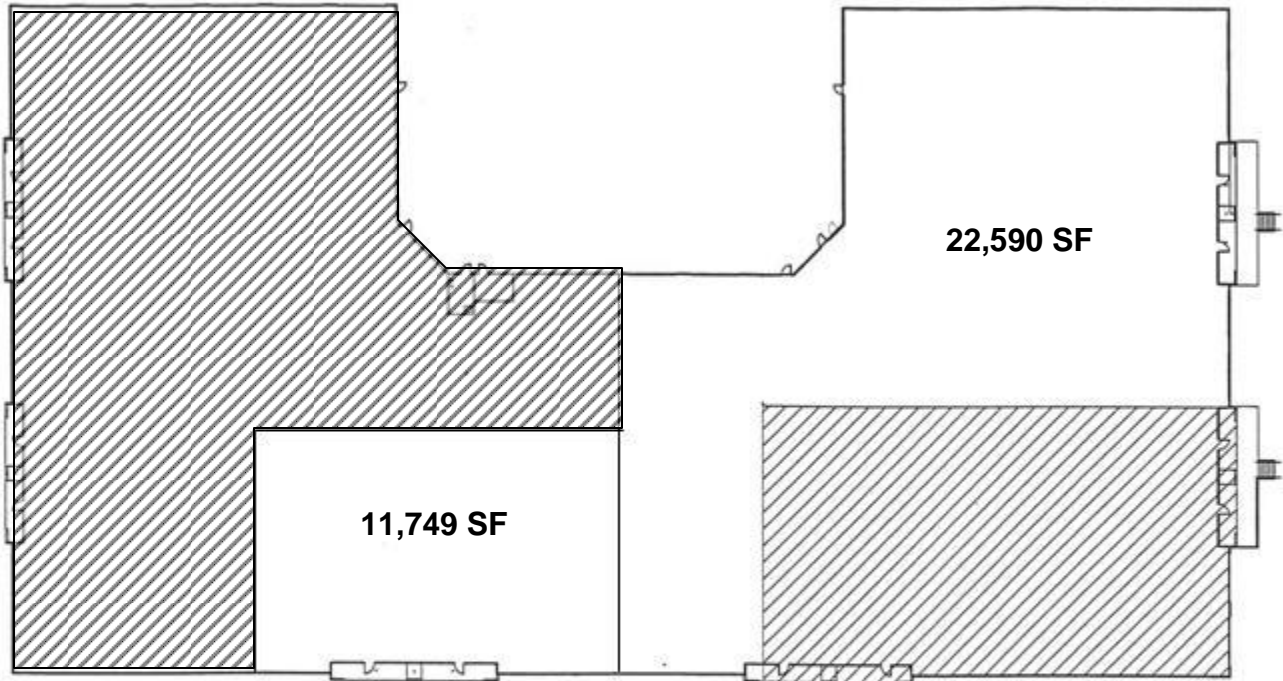

Thomas Linderman Graham Inc.

www.TLGCRE.com

Raleigh
 1511 Sunday Drive, Suite 200
 Raleigh, North Carolina 27607
 919.785.3434 919.785.0802 fax

Chapel Hill
 100 Europa Drive, Suite 190
 Chapel Hill, North Carolina 27517
 919.968.4017 919.929.7913 fax

Durham
 2200 W. Main Street
 Durham, North Carolina 27705
 919.286.5900 919.286.4191 fax

Independently Owned and Operated

The information contained herein was obtained from sources believed reliable; however, Grubb & Ellis|Thomas Linderman makes no guarantees, warranties, or representations as to the completeness or accuracy thereof. The presentation of this property is submitted subject to errors, omissions, changes of price or conditions prior to sale or lease, or withdrawal without notice.